

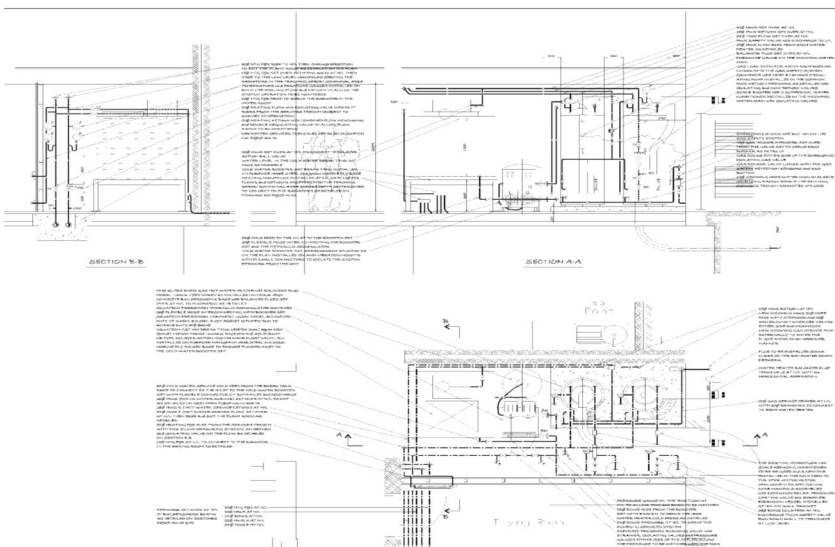

Margaret McMillan House, Wrotham, Kent



Design and build of new mechanical services and plumbing installation to the newly extended wing of this established children's holiday home.

Contract Manager: Glenn Gatehouse
Project Surveyor: Andy Mason
Site Manager: Tom Kelly

Contract Value: £140,000
Working Weeks: 16 weeks
Completion: July 2009

Client: Bryen & Langley
Architect: Playle & Partners LLP
QS: Playle & Partners LLP

